

Weller®

WHP 1000



Betriebsanleitung - Mode d'emploi - Gebruiksaanwijzing - Istruzioni per l'uso - Operating Instructions - Instruktionsbok - Manual de uso - Betjeningsvejledning - Manual do utilizador - Käyttöohjeet - Οδηγίες Λειτουργίας - Kullanım kılavuzu - Návod k použití - Instrukcja obsługi - Üzemeltetési utasítás - Návod na používanie - Navodila za uporabo - Kasutusjuhend - Naudojimo instrukcija - Lietošanas instrukcija - Ръководство за работа - Manual de exploatare - Naputak za rukovanje

Inhaltsverzeichnis

1. Achtung!	1
2. Beschreibung Technische Daten	1
3. Inbetriebnahme	1
4. Betrieb mit externem Sensor	2
5. Fehleranzeige im Display	2
6. Power On Routinen	2
7. Zubehör	2
8. Lieferumfang	2

Table des matières

1. Attention!	3
2. Description Caractéristiques techniques	3
3. Mise en service	3
4. Fonctionnement avec un capteur externe	4
5. Affichages d'erreurs sur l'écran	4
6. Autres routines Power On	4
7. Accessoires	4
8. Descriptif du contenu	4

Inhoudsopgave

1. Attenie!	5
2. Omschrijving Technische gegevens	5
3. Inbedrijfname	5
4. Gebruik met externe sensor	6
5. Foutindicaties op het display	6
6. Andere „Power On“ routines	6
7. Toebehoren	6
8. Omvang van de levering	6

Indice

1. Attenzione!	7
2. Descrizione Dati tecnici	7
3. Messa in funzione	7
4. Funzionamento con sensore esterno	8
5. Indicazione di errore nel display	8
6. Altre routine „Power On“	8
7. Accessori	8
8. Estensione della fornitura	8

Table of contents

1. Attention!	9
2. Description Technical data	9
3. Placing in operation	9
4. Operation with external Sensor	10
5. Error indications on the display	10
6. Other power- on routines	10
7. Accessories	10
8. Items supplied	10

Innehållsförteckning

1. Observera!	11
2. Beskrivning Tekniska data	11
3. Driftsättning	11
4. Drift med extern sensor	12
5. Felindikering på displayen	12
6. Andra „Power On“-rutiner	12
7. Tillbehör	12
8. Leveransomfattning	12

Seite

1
1
1
2
2
2
2
2

Page

3
3
3
4
4
4
4
4

Pagina

5
5
5
6
6
6
6
6

Pagina

7
7
7
8
8
8
8
8

Page

9
9
9
10
10
10
10
10

Sida

11
11
11
12
12
12
12
12

Índice

1. Atención!	13
2. Descripción Datos técnicos	13
3. Puesta en servicio	13
4. Servicio con sensor externo	13
5. Indicación de fallos en la pantalla	14
6. Otras rutinas „Power On“	14
7. Accesorios	14
8. Volumen de suministro	14

Indholdsfortegnelse

1. Bemærk!	15
2. Beskrivelse Tekniske data	15
3. Ibrugtagning	15
4. Drift med eksternt sensor	16
5. Fejlvisning i displayet	16
6. Yderligere „Power On“-rutiner	16
7. Tilbehør	16
8. Leveringsomfang	16

Índice

1. Atenção!	17
2. Descrição Dados técnicos	17
3. Colocação em funcionamento	17
4. Funcionamento com sensor externo	17
5. Indicação de falha no visor	18
6. Outras rotinas „Power On“	18
7. Acessórios	18
8. Fornecimento	18

Sisällyslueetelo

1. Huomio!	19
2. Lajitekuvaus Tekniset tiedot	19
3. Käyttöönotto	19
4. Käyttö ulkopuolisella sensorilla	20
5. Virheilmoitukset näytössä	20
6. Muut Power on -rutiinit	20
7. Lisävarusteet	20
8. Toimitussisältö	20

Πίνακας περιεχομένων

1. Προσοχή!	21
2. Περιγραφή Τεχνικά στοιχεία	21
3. Λειτουργία	21
4. Λειτουργία με εξωτερικό αισθητήρα	22
5. Ενδείξεις σφάλματος στην οθόνη	22
6. Περαιτέρω ρουτίνες "Power On"	22
7. Εξαρτήματα	22
8. Υλικά παράδοσης	22

İçindekiler

1. Dikkat!	23
2. Açıklama Teknik bilgiler	23
3. Devreye alma	23
4. Harici sezici ile işletim	24
5. Ekrandaki hata gösterimleri	24
6. Diğer Power On rutinleri	24
7. Aksesuar	24
8. Teslimat kapsamı	24

Página

13
13
13
13
14
14
14
14

Side

15
15
15
16
16
16
16
16

Página

17
17
17
17
18
18
18
18

Sivu

19
19
19
20
20
20
20
20

Σελίδα

21
21
21
22
22
22
22
22

Sayfa

23
23
23
24
24
24
24
24

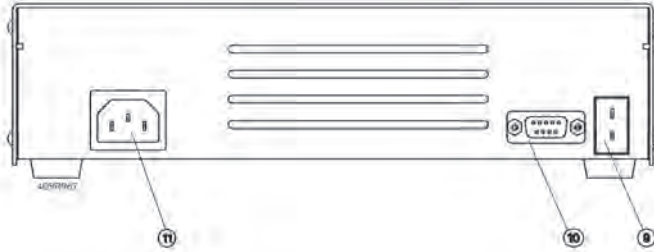
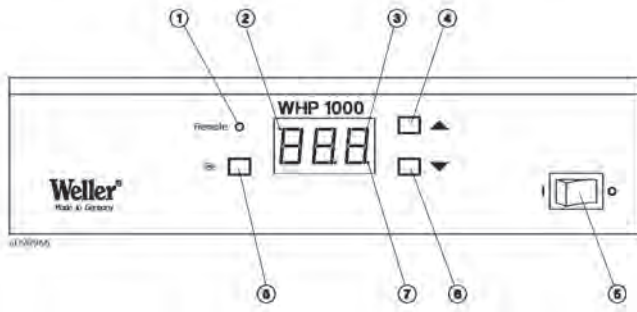

1. LED Remote (externe Ansteuerung RS232)
2. Anzeige externe Sensorregelung
3. Display (3-stellige 7-Segmentanzeige)
4. "UP" Taste
5. Netzschalter
6. "DOWN" Taste
7. Optische Regelkontrolle
8. Spezialtaste für Sonderfunktionen
9. Externer Sensor
10. RS232 Schnittstelle (externe Ansteuerung)

1. LED Remote (pilotage externe RS232)
2. Affichage régulation capteur externe
3. Ecran (afficheur 7 segments 3 caractères)
4. Touche "UP"
5. Interrupteur secteur
6. Touche "DOWN"
7. Voyant de contrôle température
8. Touche spéciale pour fonctions spéciales
9. Capteur externe
10. Interface RS232 (pilotage externe)
11. Prise secteur

1. LED Remote (externe aansturing RS232)
2. Indicatie externe sensorregeling
3. Display (3-cijferig 7-segmentdisplay)
4. "UP"-toets
5. Netspanningschakelaar
6. "DOWN"-toets
7. Optische regelcontrole
8. Speciale toets voor speciale functies
9. Externe sensor
10. RS232-interface (externe aansturing)
11. Netaansluiting

1. LED Remote (azionamento esterno RS232)
2. Visualizzazione regolazione sensori esterna
3. Display (indicatore a 3 cifre 7 segmenti)
4. Tasto "UP"
5. Interruttore di alimentazione
6. Tasto "DOWN"
7. Controllo di regolazione ottico
8. Tasto speciale per Funzioni speciali
9. Sensore esterno
10. Interfaccia RS232 (azionamento esterno)
11. Presa di alimentazione

1. Remote LED (external control via RS232)
2. Indication, external sensor regulation
3. Display (3-digit 7-segment display)
4. "UP" button
5. Mains switch
6. "DOWN" button
7. Optical indication of the state of regulation
8. Key for special function
9. External sensor
10. RS232 interface (external control)
11. Mains connection

1. LED Remote (extern aktivering RS232)
2. Indikering av extern sensorstyrning
3. Display (3-siffrigt 7-segmentindikering)
4. "UP"-knapp
5. Huvudströmbrytare
6. "DOWN"-knapp
7. Optisk reglerkontroll
8. Knapp för specialfunktioner
9. Extern sensor
10. RS232-gränssnitt (extern aktivering)
11. Nätanslutning

1. LED remoto (activación externa RS232)
2. Indicación de regulación de sensor externa
3. Pantalla (indicación de siete segmentos de tres dígitos)
4. Tecla "UP"
5. Interruptor de red
6. Tecla "DOWN"
7. Control óptico de regulación
8. Tecla especial para funciones especiales
9. Sensor externo
10. Interfaz RS232 (activación externa)
11. Conexión de red

1. LED remote (ekstern styring RS232)
2. Indikator for ekstern sensorstyrning
3. Display (3-cifret 7-segment display)
4. "UP"-taste
5. Netafbryder
6. "DOWN"-taste
7. Optisk indstillingskontrol
8. Specialtaste til specialfunktioner
9. Ekstern sensor
10. RS232-interface (ekstern styring)
11. Netttilslutning

1. LED Remote (activação externa RS232)
2. Indicação de regulação externa do sensor
3. Visor (indicação de 3 dígitos, 7 segmentos)
4. Tecla "UP"
5. Interruptor principal
6. Tecla "DOWN"
7. Controlo de regulação óptico
8. Tecla específica para funções especiais
9. Sensor externo
10. Interface RS232 (activação externa)
11. Ligação de rede

1. LED Remote (ulkoinen ohjaus RS232)
2. Ulkopuolisen sensorisäädön näyttö
3. Näyttö (3-merkkinen 7-segmenttinäyttö)
4. "UP"-painike
5. Virtakatkaisin
6. "DOWN"-painike
7. Optinen säätövalvonta
8. Erikoispainike erikoistoiminnoille
9. Ulkopuolinen sensori
10. RS232-liitäntä (ulkoinen ohjaus)
11. Verkkoliitäntä

1. Φωτοδίοδος (LED) REMOTE (εξωτερικός έλεγχος RS232)
2. Ένδειξη εξωτερικής ρύθμισης αισθητήρα
3. Οθόνη (τριψήφια ένδειξη 7 τομέων)
4. Πλήκτρο "UP" (επάνω)
5. Γενικός διακόπτης
6. Πλήκτρο "DOWN" (κάτω)
7. Οπτικός έλεγχος ρύθμισης
8. Ειδικό πλήκτρο για ειδικές λειτουργίες
9. Εξωτερικός αισθητήρας
10. RS232 θύρα διεπαφής (εξωτερικός έλεγχος)
11. Σύνδεση στο δίκτυο του ρεύματος

Quick Reference WHP 1000

- UP button increase value



- DOWN button decrease value



- Adjust Offset



- Manual heating shut down (Off)

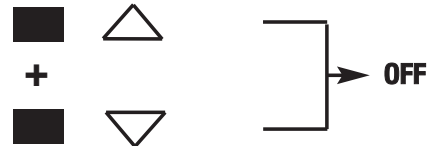

- Automatic heating shut down (Auto Off)

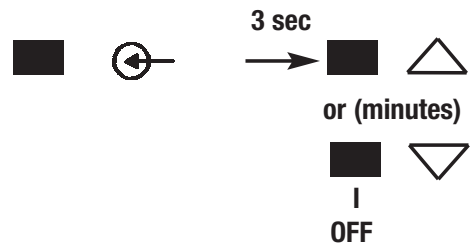

Key function via “Power-On Routine”

- Standby function



- Change over °C / °F



- Resetting to the factory setting (FSE)

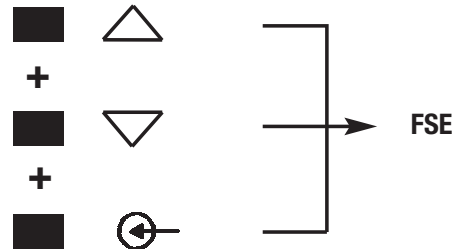

We thank for the confidence you have shown by purchasing the Weller Heating Plate WHP 1000. During manufacture the strictest quality requirements are applied; these assure the correct function of the device and make it possible to obtain optimal soldering results.

1. Attention!

Prior to placing the device in operation, please carefully read these operating instructions and the safety instructions enclosed. If the safety instructions are not observed, there is a risk of injury.

The manufacturer accepts no liability for usage other than that described in the operating instructions or for unauthorised modifications

The WELLER heating plate WHP 1000 complies with the EU declaration of conformity as per the essential safety requirements in the directives 2004/108/EU, 2006/95/EU and 2011/65/EU (RoHS).

2. Description

The WHP 1000 heating plate is equipped with 4 heating elements, each 250 W and enable electronic assemblies to be pre-heated in numerous ways. Digital regulation electronics ensure precise temperature behaviour and support various special functions such as "AUTO OFF" or standby temperature. Setpoints and actual values are indicated digitally.

With an optional external sensor, the temperature can be regulated at specific needed spots.

An integrated RS232 interface enables the device to be controlled externally from the Weller WHA 3000P / WHA 3000V hot air station. Here the WHP 1000 heating plate is used as a bottom heater in a 3-step temperature-time profile.

Technical data

Dimensions:	254 x 280 x 70 mm
(W x L x H)	10 x 10 x 2,75 inch
Heating plate:	150 x 220 mm
	6 x 8,7 inch
Mains voltage:	230 V (120 V); 50 Hz (60 Hz)
Power:	1000 W
Temperature range:	50°C - 300°C (150°F - 570°F)
Protection class:	1

3. Placing in operation

Remove all temperature sensitive and flammable objects from the vicinity of the heating plate. Ensure that the heating plate is switched off.

Ensure that the mains voltage is correct. Connect the device to the mains (11). Switch on the device at the mains switch (5). When the device is switched on, a self-test is performed during which all display elements (3) are operated. The temperature set (setpoint) and the temperature scale (°C / °F) are then displayed briefly. The display then switches automatically to the indication of the actual value. The red dot on the display illuminates (7). This dot is a visual indication of the state of the regulation.

Continuous illumination indicates the system is warming up. Flashing indicates that the operating temperature has been reached. The colour of the heated surface can change when heated for the first time.

3.1. Adjusting temperature

The digital display (3) normally indicates the actual temperature. The digital display (3) switches to the current setpoint when the "UP" or "DOWN" button (4) (6) is pressed. The setpoint (flashing indication) can now be changed as required by pressing or pressing and holding the "UP" or "DOWN" button (4) (6). If the button is pressed and held down, the setpoint changes quickly. Approx. 2 sec. after the button is released, the digital display (3) automatically switches back to the actual value.

3.2. Manual heating shut down (OFF)

The device heating is shut down by simultaneously pressing the "UP" and "DOWN" buttons. "OFF" appears on the display (3). If the standby function is also active, the temperature is reduced to 65°C (150°F). "Stb" appears on the display (3).

3.3. Adjust Temperature-OFFSET

The real surface temperature can be readjusted in a $\pm 40^{\circ}\text{C}$ ($\pm 72^{\circ}\text{F}$) OFFSET range.

1. Press key for special function (8). Display (3) show **000**
2. Set Auto-OFFSET-temperature value with key "UP" or "DOWN". After 4 sec. the Display switch back to actual value.

3.4. Automatic heating shut down (AUTO OFF function)

The auto off time for the heating shut down is displayed flashing by pressing and holding (approx. 3 sec.) the key for special function (8). The shut-down time can be adjusted in 5 minute steps in the range 5 - 600 min by pressing the "UP" or "DOWN" button (4) (6). A setting of less than 5 min switches off the automatic heating shut-down and "OFF" appears on the display (4).

If the standby function is also active, the temperature is reduced to 65°C (150°F). "Stb" appears on the display (3).

3.5. Operation using RS232 serial interface

When operated together with the WHA 3000P / WHA 3000V hot air station, the WHP 1000 heating plate is controlled via

the RS232 serial interface (10).

Here the heating plate is used as a bottom heater for electronic assemblies and is integrated into a 3-step temperature-time profile.

When used in automatic mode (Remote LED (1) illuminated) it is not possible to make any entries directly at the heating plate.

The temperature setting is made via the WHA 3000P / WHA 3000V hot air station.

When the program is not active, the heating plate is switched off. "OFF" appears on the display (3).

If the standby function is also active, the temperature is reduced to 65°C (150°F). "Stb" appears on the display (3).

3.6. STANDBY function

In standby mode the temperature is reduced to 65°C (150°F) if a heating shut-down occurs (using OFF, AUTO OFF, RS232). The standby mode is activated via a "Power-On Routine".

For this purpose the device is first switched off at the mains switch (5). Press the key for special function (8) and switch on the device. Keep button pressed until the - 1 - appears on the display (3). When the key for special function is released the setting is saved. The standby function is switched on.

Use the same procedure for switching off. - 0 - appears on the display (3) (factory setting).

4. Operation with external Sensor

It is also possible to measure the control variable for the temperature regulation using an external sensor. If an external sensor is connected, the current temperature from the external sensor is displayed and controlled instead of the temperature of the heating lamps.

The external sensor, an insulated thermocouple type K, is connected to socket (9). LED (2) on the display (3) illuminates.

Note:

The sensor must be adequately in contact with the assembly or component for correct operation. When working with the external sensor, the temperature setting (setpoint) must be adjusted to suit the measuring point.

5. Error indications on the display (3)

- - - No temperature sensor detected
E10 Maximum housing temperature exceeded

6. Other power-on routines

°C / °F change over

For this purpose the device is first switched off at the mains switch (5). Press "DOWN" button (6) and switch on the device. Keep button pressed until the "°F" appears on the display (3). When the "DOWN" button is released the setting is saved. Use the same procedure for the change over to "°C".

Resetting to the factory setting (FSE)

For this purpose the device is first switched off at the mains switch (5). Press "UP" (4) + "DOWN" (6) + key for special function (8) simultaneously and switch on the device. Keep buttons (4, 6, 8) pressed until "FSE" appears on the display (3). When the buttons (4, 6, 8) are released the setting is saved.

7. Accessories

External sensor type K (0.5mm)	5 31 190 99
Interface cable	5 31 191 99
WBH2 Circuit board holder	5 33 167 99
WBHS Circuit board holder with stand	5 33 165 99
WHA 3000P Hot air station	5 33 346 99
WHA 3000V Hot air station	5 33 366 99

8. Items supplied

WHP 1000 heating plate
Mains cable
Operating instructions
Safety information

Circuit Diagram, see page 47

Exploded Diagram, see page 48

Subject to technical change without notice!

See the updated operating instructions at www.weller-tools.com.

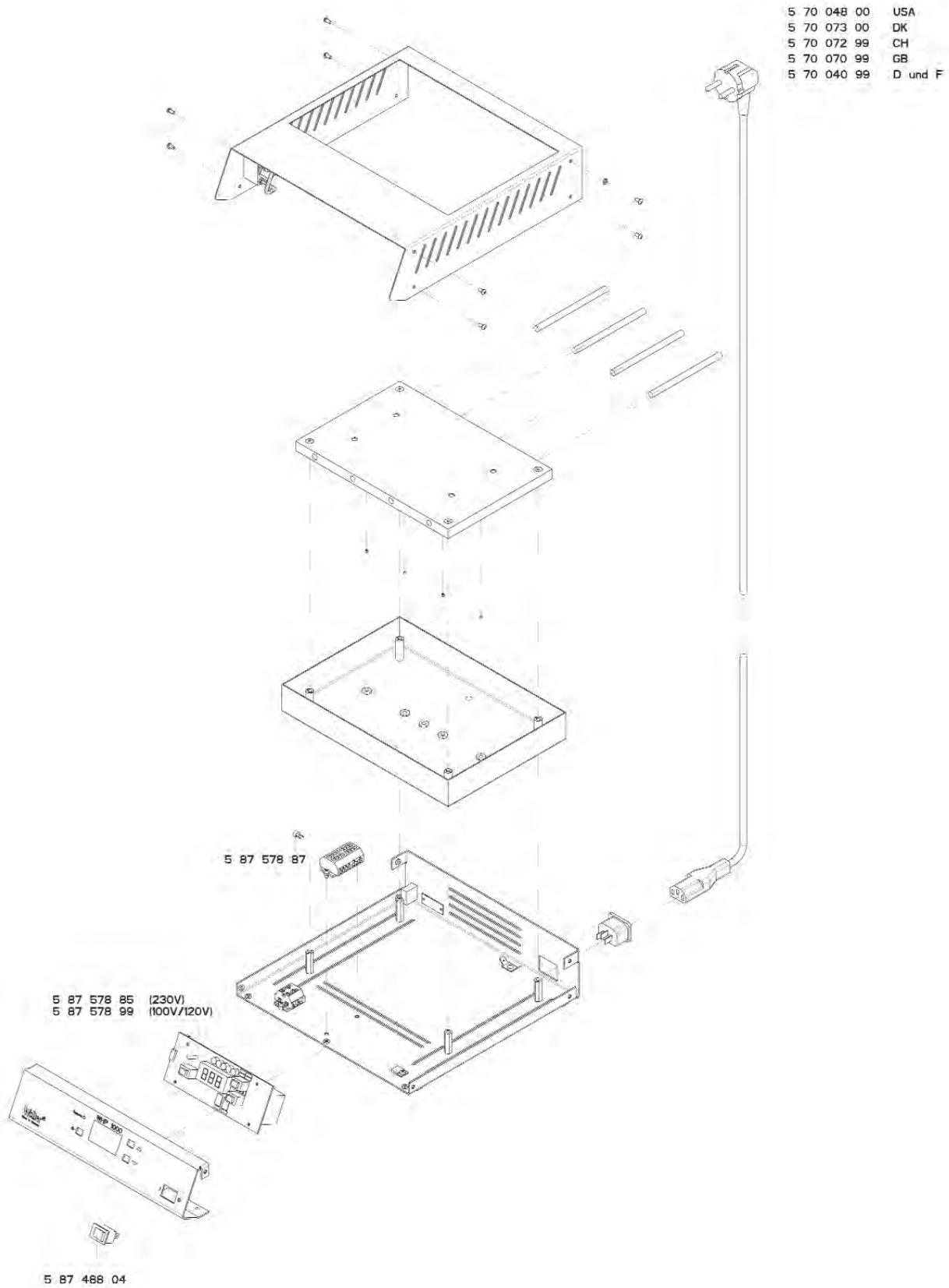

WHP 1000
 4D9R971/2

T005 57 172 06 / 12.2014
T005 57 172 04 / 10.2012

Weller[®]

Weller[®] is a registered Trademark and registered Design of Apex Tool Group, LLC

Find Quality Products Online at: www.GlobalTestSupply.com

sales@GlobalTestSupply.com